



# Instruction Manual of nile air tools — Original instructions —

## Use

Only by setting a file and a saw blade , you can rework the molds , deburring of Die Casting Work , and cutting of thin steel plate.

※EN ISO 11148-12:2012

|              |                 |
|--------------|-----------------|
| Product name | nile air tools  |
| Model No.    | AF5A (FIL-SAWS) |

## Attention on safe of this product

- In order to prevent accidents, such as an injury, be sure to follow "attention on safe" expressed below.
- Before use — this "attention on safe" — use it correctly according to directions after often reading all.
- Be sure to keep it to the place where those who use are seen always after reading.



## WARNING

<Before work > Intercept an air source of supply at any cost at the time of air hose desorption.

### ①Do not use any power source except an air compressor.

- The tool is designed to operate on compressed air.

Use only air compressed by air compressors. Do not use any other power source , such as high pressure gas of oxygen , acetylene , propane , etc. which will cause explosive hazard .

### ②Use it for the work which suited the use.

- This machine is a tool in cutting job with a saw blade, and grinding job by a file.

- Do not use it in addition to the specified use.

If cutting and grinding beyond capability are carried out, it becomes a cause of breakage of a saw blade and a file, a breakage part should fly, and since it is dangerous, never make it absolute.

### ③Please do not bring a child close.

- Do not let me touch air fil saw and an air hose except a worker. It becomes a cause of an injury.

- Do not bring close to a workplace except a worker. It becomes a cause of an injury.

### ④Keep work area clean.

- The untidy place and working table cause an accident.

- Make a workplace bright enough. A dark workplace causes an accident.

### ⑤Dress properly . Too large dress and long hair cause an accident.

- In order to protect an ear from the exhaust sound and exhaust air , always wear hearing protective equipment.

### ⑦Use protective equipment.

- Wear a protective glove.

- In cutting and grinding, use an eye shield.

### ⑧Wear protectors, such as a helmet, safety shoes, and a protection-against-dust mask, according to work environment.

### ⑨Carry out checking the following items before connecting an air hose.

- The screws of a saw blade and a file , the main part connection part, and the air piping part don't be loose.

- Be damaged or there need to be no detached parts.

- There need to be no parts in which rust does not operate normally owing to.

Use in the state of being abnormal is forbidden strictly. It becomes an accident and a cause of an injury.

Request repair from the purchased store or Muromoto at the time of an abrupt increase.

### ⑩Be careful of the following thing when you connect an air hose.

- A hand cannot be touched at a lever.

- The connector to use, please prepare a metal connector.

Please refer to PNEUMATIC CIRCUIT DIAGRAM in page 9.

### ⑪Connect an air hose and carry out the next check, before attaching a saw blade and a file.

- There should be neither an air leak nor unusual sound.

Use in the state of being abnormal is forbidden strictly. It becomes an accident and a cause of an injury.

Request repair from the purchased store or Muromoto at the time of an abrupt increase.

### ⑫Attach a saw blade and a file certainly according to an operation manual.

- If not certain, it will separate and will become a cause of an injury.

### ⑬Use appointed accessories and attachment.

- Use neither the accessories of the specification written in this operation manual and our catalog, nor things other than an attachment. It becomes an accident and a cause of an injury.

### ⑭Do not use it, when the saw blade and the file have modification and a crack.

<Under work > Intercept an air source of supply at any cost at the time of air hose desorption.

**①Use the appointed air pressure power.**

•The use air pressure power range of this machine is 0.55 – 0.65MPa. Use it within the limits of this.  
If it is used by the air pressure power beyond 0.65MPa, there will be a burst of the body and fear of damage and it will become a cause of an injury.

**②During use, do not turn tip parts, such as a saw blade and a file, to an operator or other persons, or bring neither a hand nor a face close.**

•It becomes a cause of an injury.

**③Do not use it in a place with an inflammable liquid or gas.**

•Do not use this machine in a place with the existing inflammable liquid or gas, such as thinner, gasoline, a paint, and gas. Suction compression is carried out together with air, there is fear of explosion or a fire, and it becomes a cause of an accident. It is not designed in the purpose of use in explosive environment.

**④Do not touch a saw blade and a file other than the time of a saw blade and a file exchange and trouble generating.**

•Since a saw blade and a file are operating at high speed, do not touch a saw blade and a file  
or each air filsaw should not bring fingers on the outskirts close

**⑤In the following case, please remove an air hose and extract compressed air.**

**(There is a possibility that the stored air may cause danger.)**

•It is after use at the case where it is not used, or the time of work discontinuation.

•In the cases of check, repair, adjustment, etc.

•When accessories, such as a saw blade and a file, are exchanged.

•When moving an air filsaw and delivering by hand.

The air filsaw operates accidentally and it becomes a cause of an injury.

**⑥Do not let me desorb an air hose, where a finger is applied to a lever.**

•The air filsaw operates accidentally and it becomes a cause of an injury.

**⑦A workpiece should work fixing firmly.**

**⑧Be careful of a surrounding person during work.**

•Since cutting and grinding has a possibility that scraps etc. may hit in use, do not let an outsider enter within a 1-m radi  
It causes the injury.

•Be sure to confirm well that there are no people, and to use a fall prevention implement downward,  
at the time of height work, to equip it with it.

It becomes a cause of an accident when this machine and material are dropped.

**⑨In the work to a weak material, cause a harmful fragment and be careful.**

•Be careful of working leaning the head etc. in the work which discharge of a facet etc. generates.

**⑩Hold an air filsaw certainly during use not to be rejected about.**

•It will become a cause of an injury if it does not hold certainly.

**⑪Do not work with an impossible posture.**

•Always brace a step and maintain balance.

**⑫Work being careful enough without being inattentive.**

•When you use an air filsaw, be careful of the handling method, the method of work, a surrounding situation, etc.  
enough, and work carefully.

•The untidy place causes an accident.

• Make the workplace bright enough. Work at a dark place becomes a cause of the accident.

•Do not use it, when you are tired.

**⑬Perform the handling of a product carefully.**

•Please never raise and lower, carrying the product by using the air hose.

•Please note that the air hose has the possibility of the whip.

**⑭Keep in mind that this air filsaw is not insulated for contact with the electric power source.**

**⑮When you drop accidentally or you throw, check well that there are not breakage, a crack, and modification in the body etc.**

•There is fear of a burst by internal compressed air, and it becomes a cause of an injury.

**⑯During use, when the body is out of condition or you feel abnormalities, stop use immediately and request repair from the store or the Muromoto ironworker of a purchase.**

**⑰Since there is vibration at the time of work, do not carry out prolonged continuous use.**

<After work > Intercept an air source of supply at any cost at the time of air hose desorption.

- ①After work should remove an air hose at any cost.
  - ②Neglect the air filsaw and the air-conditioner presser, hit to direct rays for a long time, and come out.
  - ③An air filsaw should repair carefully.
  - ④When you do not use it, please keep it exactly.
  - ⑤Do not remove parts or do not convert.
  - ⑥Do not use anythings other than the recommended lubricous material.
  - ⑦Request repair of the air filsaw from the specialty store.
- Be sure to tell the store or Muromoto of a purchase repair.  
If it fixes by itself, it will become an accident and a cause of an injury.

## Machine construction (Parts list)

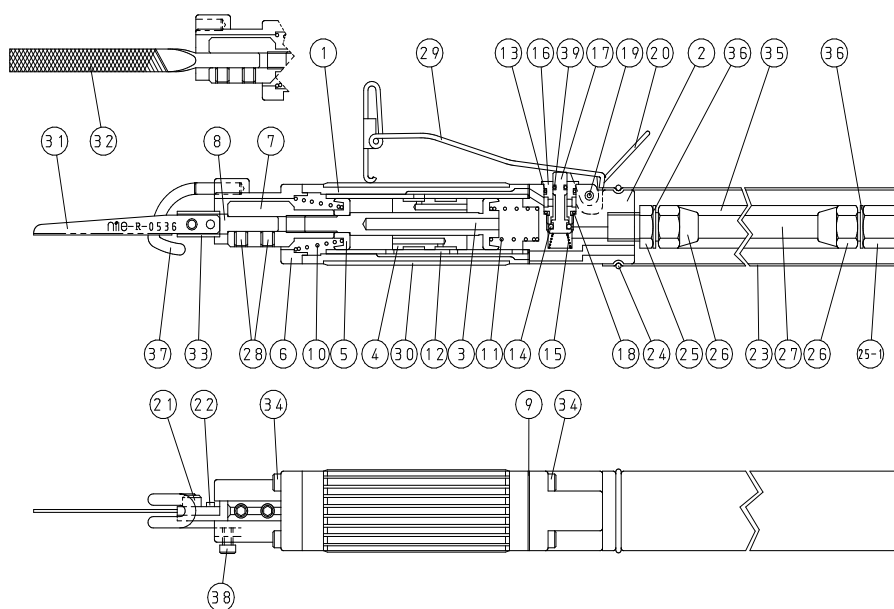

| No.  | DESCRIPTION              |
|------|--------------------------|
| 1    | Main cylinder            |
| 2    | Regulator valve case     |
| 3    | Piston rod               |
| 4    | Work piston              |
| 5    | Operate piston           |
| 6    | Head                     |
| 7    | Holder cap               |
| 8    | Blade holder             |
| 9    | Plastic plate            |
| 10   | Front spring             |
| 11   | Rear spring              |
| 12   | Inner cylinder           |
| 13   | O ring                   |
| 14   | O ring                   |
| 15   | Spring                   |
| 16   | Air valve                |
| 17   | Valve pin                |
| 18   | O ring                   |
| 19   | Spring pin               |
| 20   | Hanger                   |
| 21   | Set bolt                 |
| 22   | Set pin                  |
| 23   | Muffler                  |
| 24   | Ring                     |
| 25   | Hose nipple              |
| 25-1 | Hose nipple              |
| 26   | Hose nipple              |
| 27   | Air hose                 |
| 28   | Set bolt                 |
| 29   | Lever                    |
| 30   | Cylinder cover           |
| 31   | Saw                      |
| 32   | File                     |
| 33   | Plate for fixing the saw |
| 34   | Cap bolt                 |
| 35   | Urethane foam            |
| 36   | E ring                   |
| 37   | Attachment for saw       |
| 38   | Set bolt                 |
| 39   | O ring                   |

## Equipment supplied

- ①Hexagonal wrench 2.5mm = one
- ②Hexagonal wrench 3.0mm = one
- ③Saw blade holder(with R0536) = one
- ④Only saw blade(R0536) = one
- ⑤File(Triangle) AFT50 = one
- ⑥File(Flat) AFF50 = one
- ⑦File(Round) AFR50 = one

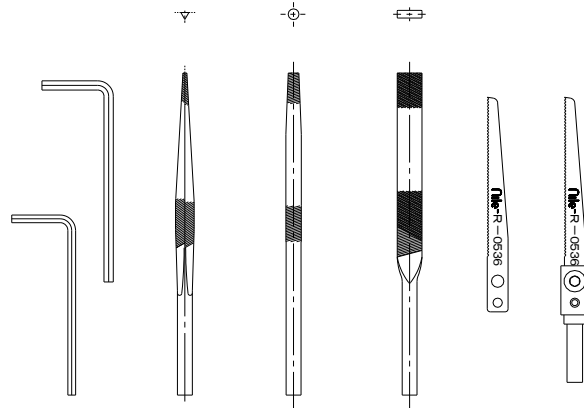

## Product specification

|  |  |                                     |               |
|--|--|-------------------------------------|---------------|
| Model No.  | AF5A   |                                     |               |
| Product name   | nile air tools   |                                     |               |
| Product description  | This tool is supplied with compressed air from the compressor will be the power source.<br>It is held firmly by hand , attach the saw blade and file dedicated to the tip , you can work |                                     |               |
| Length (mm) Body only  | 158  |                                     |               |
| Weight (g) Body only   | 490  |                                     |               |
| Grip diameter (□)  | 29 × 29  |                                     |               |
| Air consumption (ℓ/minute)                                     | 200  |                                     |               |
| Operated reciprocating rotation(time/minute):Noload            | 3,500  |                                     |               |
| Stroke(mm)   | 5  |                                     |               |
| Maximum working pressure(Mpa)                                  | 0.65   |                                     |               |
| Noise emission values<br>(based on ISO 15744)                  | A-weighted sound pressure level: dB(A)   | A-weighted sound power level: dB(A) | Uncertainty K |
|  | 70.3   | 75.2                                | 2.02          |
| Vibration values<br>(3 axes integrated:<br>based on ISO 20643) | Vibration value: m/s <sup>2</sup>  |                                     | Uncertainty K |
|  | 32.3   |                                     | 3.35          |

## Maintenance

**Be sure to observe maintenance check.**

**If check is neglected, it will become an accident and a cause of failure.**

**Be sure to perform maintenance check before work and after work.**

Remove an air hose at any cost in the case of check and care.

- Check whether there is neither dirt nor a crack in the appearance of a main part and an air hose.
- Check whether there is neither slack nor an air leak in each connection part, the screw, the nuts, main part, and air charging line part of a main part.

If it is used in the state where it loosened, the accident in the circumference of a worker and a workplace may be caused, and the lack of ability by main part breakage or air leak is caused.

- Check that the set bolt(28) is not loose.
- Carry out the check of operation of whether the air filisaw is operating normally.  
(Refer to the diagram of an operation manual of operation for normal operation. )
- Confirm whether to find abnormality in the air compressor.  
( Refer to the operation manual of an air compressor for details. )

- The scupper method of an air compressor

If an inside is covered with water or oil, it will become a cause of failures, such as generating of rust.

Remove the oil or water from inside the air compressor by drain port, before and after using

Use the dry pure compressed air.

( Refer to the operation manual of an air compressor for details. )

- For piping and lubrication.

Be sure to use the air which let the air filter pass and which does not contain moisture.

Remove finely so that the garbage adhering to a nipple, etc. do not enter in a hose.

Time and continuous work before and after use , lubricate every hour.

※Since shortly after refueling in the shape of the spray flying through the air and oil , no-load operation will take about 10 seconds it takes effect where there is no oil , let the oil circulate inside.

- Recommended lubricant

FC purpose (JIS) yanase seiyu hydraulic oil #32

R&O type ISOVG #32

Do not use anything other than the recommended lubricant.

- Use it by the appointed air pressure power.

It is maximum use air pressure power 0.65MPa of this machine.

Use it within the limits of this.

If it is used by the air pressure power beyond 0.65MPa, there will be a burst of the body and fear of damage and it will become a cause of an injury.

- Use the appointed accessories.

Please do not use anythings other than the accessories of the specification written in this operation manual and our catalog .

Since there is a possibility of becoming a cause of accidents, such as an injury.

- The use by an abnormal condition causes an injury and breakage of the body.

Request repair from the store or our company of a purchase in the case of abnormalities.

Neglect neither this machine nor an air compressor, hit to direct rays for a long time.

This machine should repair carefully.

When you do not use it, please keep it exactly.

Do not remove parts or do not convert.

I will carry out the product given unjust decomposition and reconstruction

the outside of the object of a guarantee.

No responsibility for the failure accompanying a user's own reconstruction act or fault is taken.

## ●Method lubrication

Install the lubricator through an air filter , or before and during continuous from the inlet hose nipple, be sure to lubricate the oil 6 drops every hour is recommended. Moreover , even after use and lubricate , keep working after about 30 seconds.

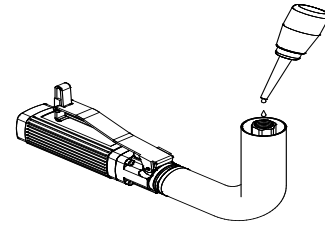

## ●Installing the filing (before the work is sure to be blocking the air source)

- ①Remove the attachment for saw(37). Loosen the set bolt(38).
- ②Tighten the set bolts(28) as possible into the filing.

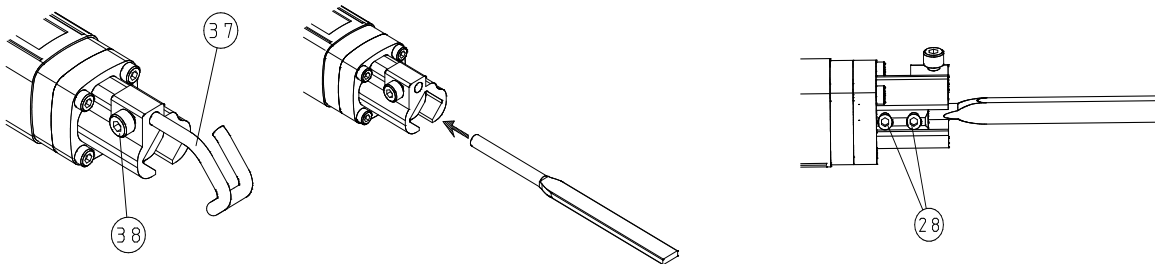

## ●How to mount a saw blade (before work can not be sure of the air supply cut off)

- ①Remove the attachment for saw(37). Loosen the set bolt(38).

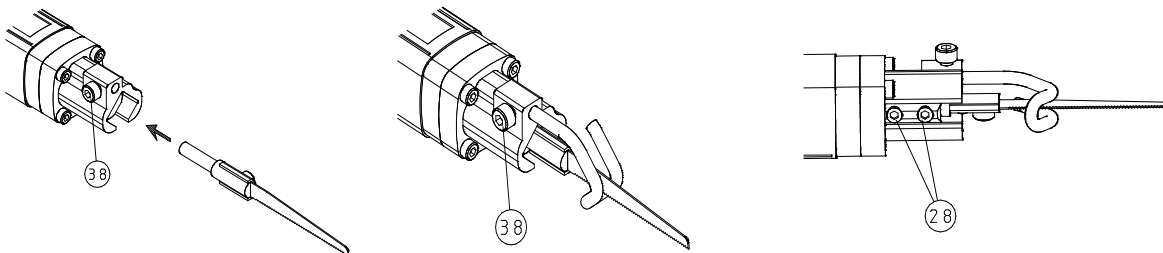

- ②Tighten the set bolts(28) as possible into the blade holder.
- ③Insert the attachment for saw(37), and tighten the set bolt (38) completed.

## ●Exchange of saw to the saw holder, how to install.

- ①Remove the set bolt(21).
- ②Remove the plate for fixing the saw(33).
- ③Install in accordance with the set pin(22) holes of the back side of saw(31).
- ④Installing a plate for fixing the saw(33).
- ⑤Tightening the set bolt(21).

### ●Air hose (with silencer cover) exchange method

- ①Remove the ring(24) using the tools.
- ②Remove the muffler(23) slide the hose nipple(25).
- ③Attach the hose nipple(25) tighten.
- ④Spend a muffler(23) the interior of the valve case(2).
- ⑤Attach the ring(24) using the tool.
- ⑥Complete replacement hose exit.

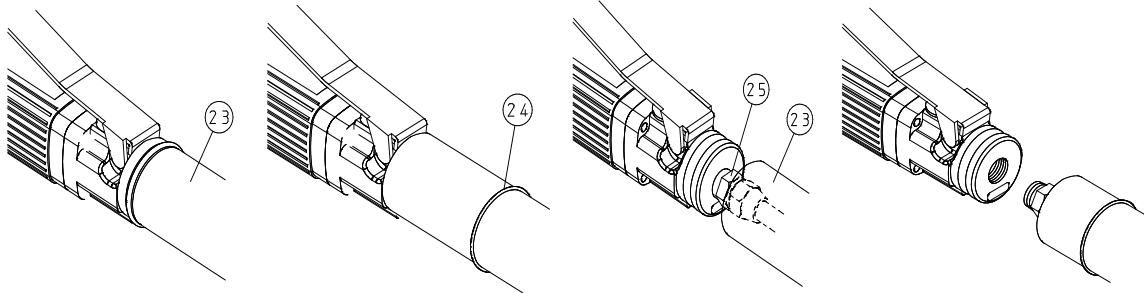

※Air hose (with muffler) consisted of a set

- |                        |                        |
|------------------------|------------------------|
| 23 Muffler = one       | 26 Hose nipple = two   |
| 24 Ring = one          | 27 Air hose = one      |
| 25 Hose nipple = one   | 35 Urethane foam = one |
| 25-1 Hose nipple = one | 36 E ring = two        |

### Appearance dimensional drawing

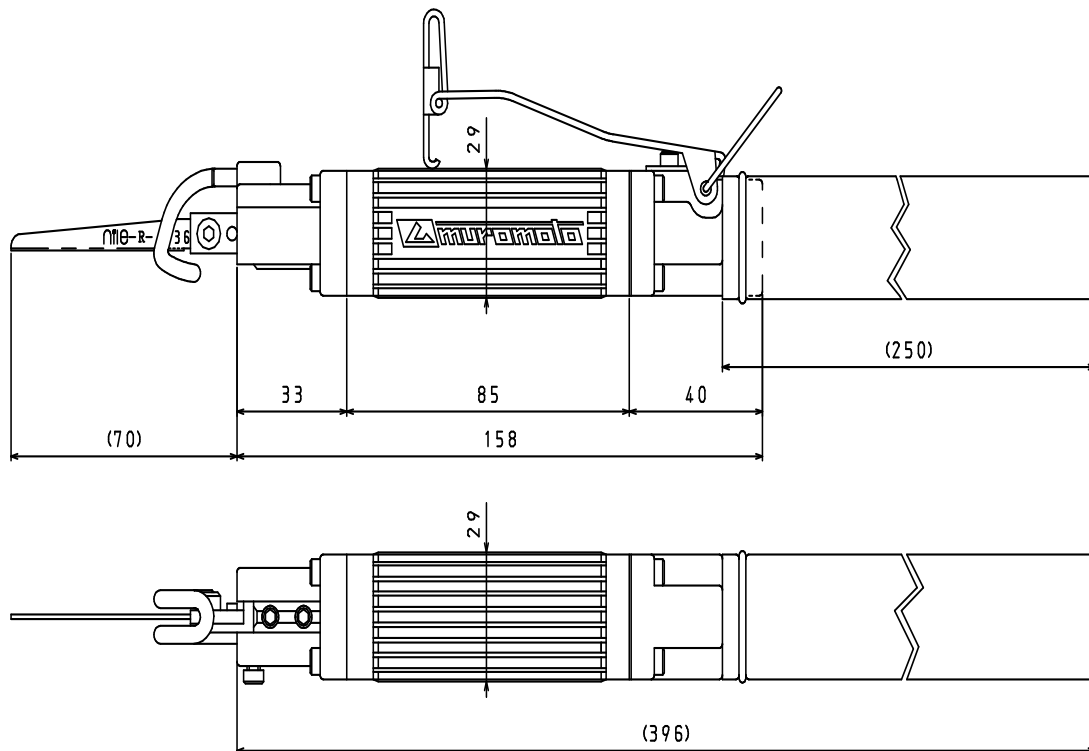

## Directions for use

- When used as a saw and file, press the lever to put the switch before hitting things always cut.  
When you switch to the object in contact with the saw and file, you may bite into the object stuck in the saw and file.
- Put the switch when the object is contacted with the saw and file, start pushing slowly working.  
Working in the tip of saw and file, never stop.  
Mechanical failure , which carries with it the risk of accidents caused by damage to the saw and file.
- If you stop working , return the lever away from the object after finishing the saw and file.  
May be bite into the object stuck in the saw and file.

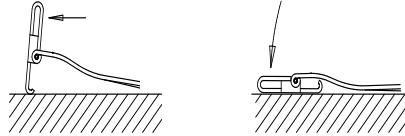

### ● A diagram of operation

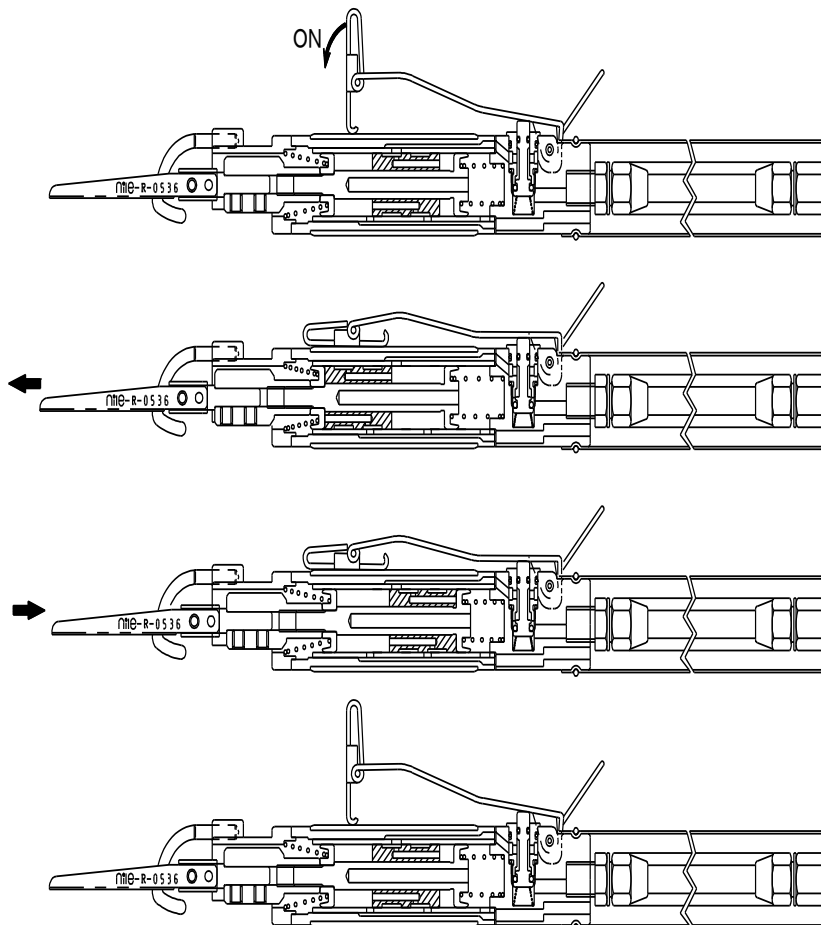



## ●The air supply method (circuit)

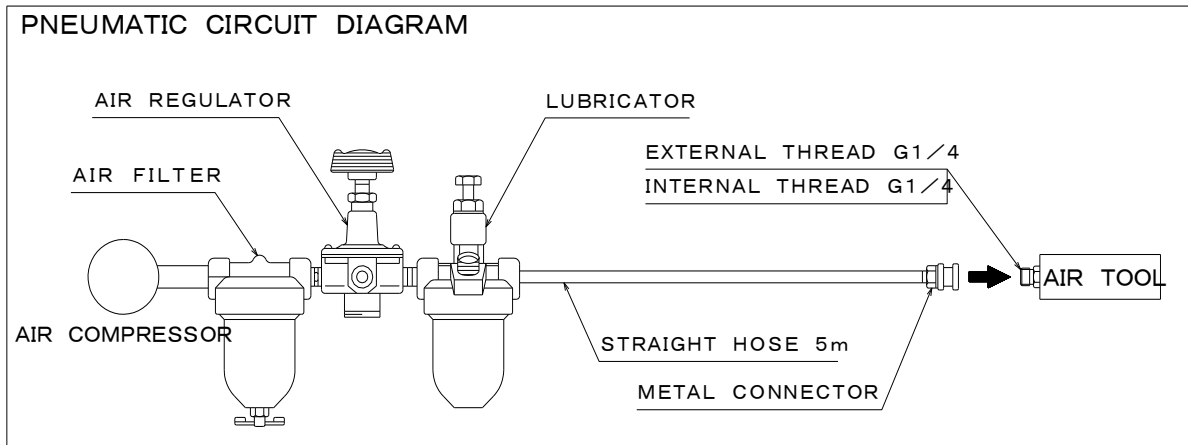

## Warning label • Information label

### ●Warning label



: Read the instruction manual  
before usage of air nipper

### ●Warning label attachment position

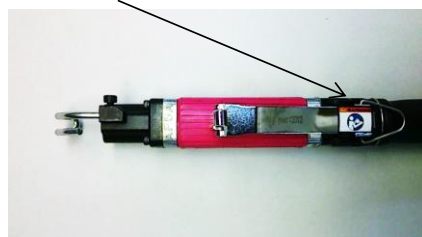

### ●Information label

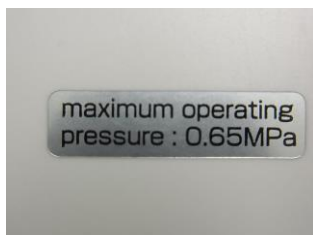

• Air Pressure



• CE mark

### ●Information label attachment position

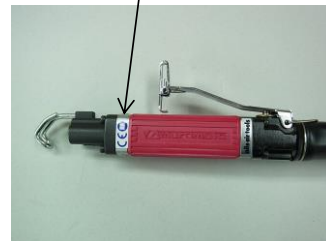
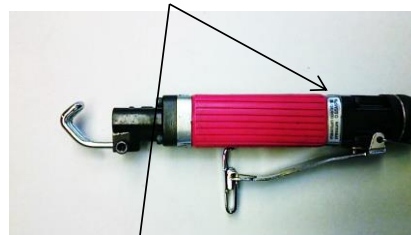

### ●Serial No.



### ●Model No.



## At the time of repair

This product is manufactured in strict accuracy.

Request the store or the Muromoto TEKKO of a purchase without never fixing in person,  
when it stops operating normally.

If it fixes by itself, it will become an accident and a cause of an injury.

In addition, when you are on the case where he wants parts, or handling and it is troubled, please ask.



Manufacturer.

Merry - Brand, Hand Tools & Nile - Brand, Pneumatic Tools

**MUROMOTO TEKKO CO.,LTD.**

8-1,1- CHOME, SHODAI-TAJIKA,HIRAKATA CITY  
OSAKA 573-1132 JAPAN

TEL. +81-72-850-0091 FAX. +81-72-850-0082

<http://www.muromoto.co.jp> E-mail: [mrt.info-f@muromoto.co.jp](mailto:mrt.info-f@muromoto.co.jp)

## EC DECLARATION OF CONFORMITY

We , the undersigned,

|              |   |
|--------------|---|
| MANUFACTURER | MUROMOTO TEKKO CO . , LTD.                                    |
| ADDRESS      | 8-1, 1-CHOME , SHODAI - TAJIKA , HIRAKATA CITY OSAKA 573-1132 |
| COUNTRY      | JAPAN   |
| PHONE NUMBER | +81-72-850-0091   |
| FAX NUMBER   | +81-72-850-0082   |

under our sole responsibility , declare that the product

|              |               |
|--------------|---------------|
| Product name | Nile Airtools |
| Model No.    | AF5A          |
|              |               |

complies with the provisions of following European Directives.

|                    |                                 |
|--------------------|---------------------------------|
| European Directive | Machinery Directive, 2006/42/EC |
|                    |                                 |

Applied Harmonized Standards:

|                                  |   |
|----------------------------------|---|
| Machinery Directive , 2006/42/EC | EN ISO 12100:2010<br>EN ISO 11148-12:2012 |
|----------------------------------|---|

The Technical documentation is kept at the following address.

|                   |   |
|-------------------|---|
| Company in Europe | SAS AUTOMATION ROBOTERGREIFSYSTEME GMBH |
| Address           | BANNWALDALLEE 60, D-76185, KARLSRUHE    |
| Country           | GERMANY                                 |
| Phone number      | +49 (0) 721 - 26306 - 10                |
| FAX number        | + 49 (0) 721 - 26306 - 22               |